



Strive™
Under-mount Kitchen Sink
K-5286

Features

- Single bowl.
- Squared bowl.
- Includes a sink bridge utility shelf with dishcloth bar and a bottom basin rack.
- 24" (610 mm) x 18-1/4" (464 mm)

Material

- 16-gauge stainless steel.

Technology

- Includes SilentShield® sound-absorption system.

Installation

- Under-mount.
- Includes installation hardware.

Components

Additional included component/s: Hardware kit, and Cut-out template.



Codes/Standards

ASME A112.19.3/CSA B45.4

See website for detailed warranty information.

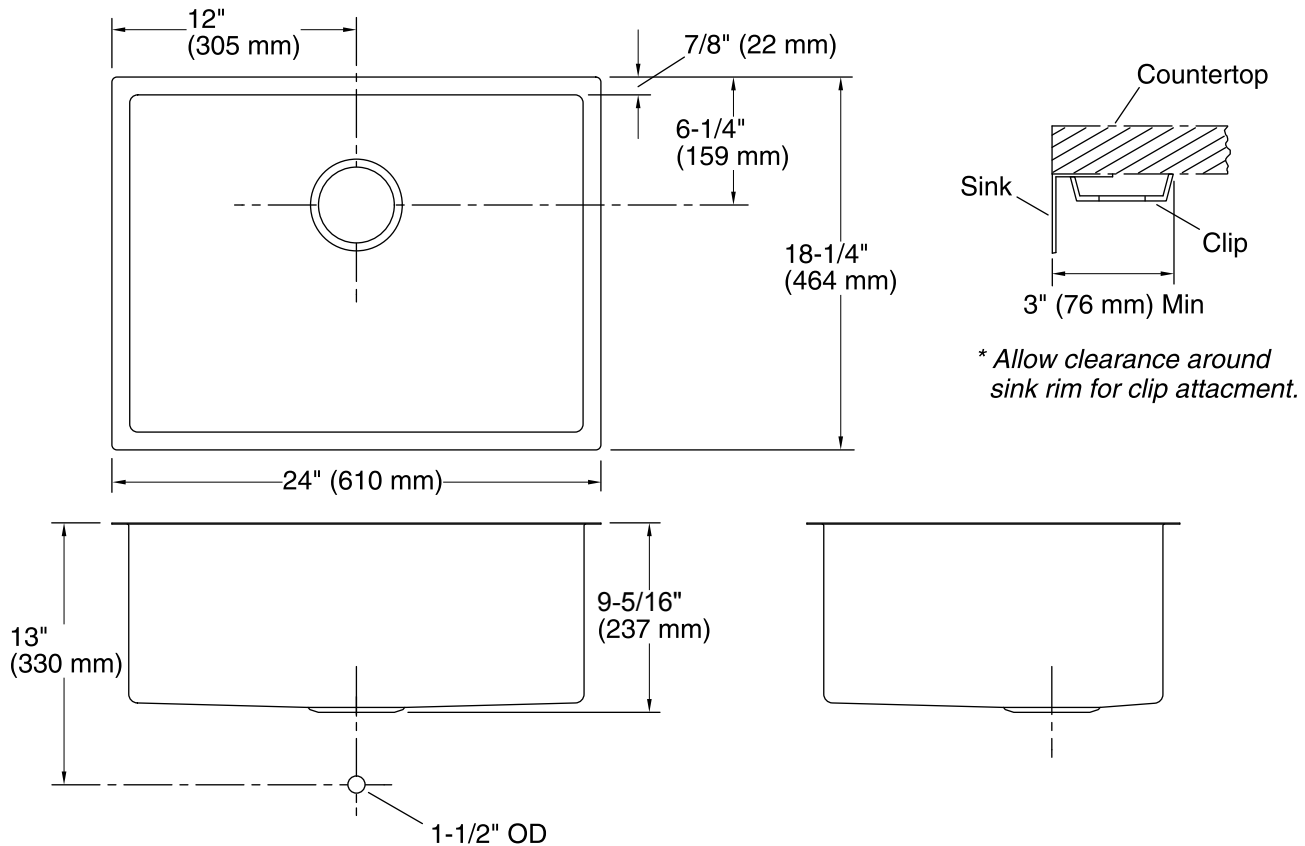

Technical Information

All product dimensions are nominal.

Bowl configuration: Single

Installation: Under-mount

Min. base cabinet width: 27" (686 mm)

Bowl area

- Length: 22-1/4" (565 mm)
- Width: 16-1/2" (419 mm)
- Bowl depth: 9-5/16" (237 mm)
- Water depth: 9" (229 mm)

Template: Under-mount, 1207218-7, not required, not included

Notes

Install this product according to the installation guide.